

Antrieb 120 V

Actuator 120 V

A 1xx05



MONTAGE



Assembly
Montage
Montaje
Montaggio
Montering
Montaž
Asennus
МОНТАЖ

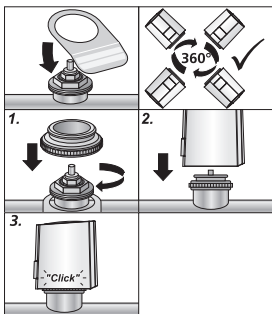

DEMONTAGE



Disassembly
Démontage
Desmontaje
Demontage
Demontaggio
Demontering
Demontaž
Purkaminen
ДЕМОНТАЖ

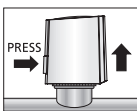

ANSCHLUSS

Connection
Raccordement
Collagemento
Connexión
Verbinding
Podłączenie
Forbindelse
Förbindelse
Sähköinen liitäntä
соединение



~ 120 V

weiß - white - blanc
- bianco - blanco -
wit - biały - hvid
- vit - valkoinen -
белый

schwarz - black -
noir - zwart - nero
- czarny - sort - svart
- muusta - negro -
черный

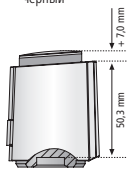
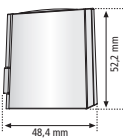

Optional First-Open

A 10x05-00

Stromlos-zu
Normally Closed

NC

„First-Open“-Funktion
"First-Open" function
Fonction „First-Open“
Función de contacto abierto
"First-Open" functie
Funkcja „first open“

Funzione "First-Open"
"First-Open" funksjon
"Första-gången" funktion
"First-Open" toiminta
функция „first open“

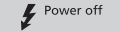
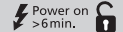
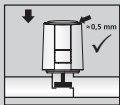
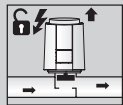
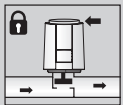

A 10x05-10

Stromlos-zu
Normally Closed

NC

Anpassungskontrolle
Adaption check
Contrôle de l'ajustement
Control de adaptación
Aanpassingscontrole
Controllo del combadamento

Kontrola dopasowania
Tilpasningskontrol
Tilpasningskontroll
Justeringskontroll
Sopivuuden tarkistus
контроль приспособления

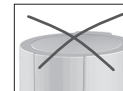
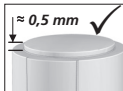

Funktionsweise
Function mode
Mode de fonctionnement
Funcionamiento
Werkwijze
Modo di funzione

Zasada działania
Funktionsmåde
Funksjonsmodus
Funktionssätt
Toimintaperiaate
принцип действия

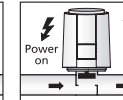
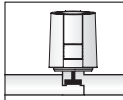

A 11x05-10
Stromlos-offen
Normally Open

NO

Funktionsweise
Function mode
Mode de fonctionnement
Funcionamiento
Werkwijze
Modo di funzione

Zasada działania
Funktionsmåde
Funksjonsmodus
Funktionssätt
Toimintaperiaate
принцип действия

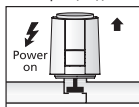
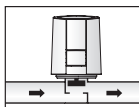

STELLWEG

| | Version NC | Version NO |
|------------|-------------------|-------------------|
| Stroke | 4,0 mm = A 10405 | 4,0 mm = A 11405 |
| Course | 5,0 mm = A 10505 | 5,0 mm = A 11505 |
| Corse | | |
| Golge | | |
| Slag | | |
| Skok | | |
| Iskupituus | | |
| длина хода | | |

DEU

Technische Daten:

| | |
|-----------------------|-----------------------------------|
| Betriebsspannung: | 120 V AC, -15 %...+15 %, 50/60 Hz |
| Betriebsleistung: | 1 W |
| Einschaltstrom, max.: | < 450 mA für max. 100 ms |
| Stellkraft: | 100 N +5 % |
| Schutzgrad: | IP 54 |
| Umgebungstemperatur: | 0 °C ... 60 °C |
| Lagertemperatur: | -25 °C ... 60 °C |

ENG

Technical Specifications:

| | |
|----------------------|-----------------------------------|
| Operating voltage: | 120 V AC, -15 %...+15 %, 50/60 Hz |
| Operating capacity: | 1 W |
| Max. inrush current: | < 450 mA for max. 100 ms |
| Actuating force: | 100 N +5 % |
| Type of protection: | IP 54 |
| Ambient temperature: | 0 °C ... 60 °C |
| Storage temperature: | -25 °C ... 60 °C |

FRA

Spécifications techniques:

| | |
|----------------------------------|-----------------------------------|
| Tension de service: | 120 V AC, -15 %...+15 %, 50/60 Hz |
| Capacité de fonctionnement: | 1 W |
| Courant de fermeture du circuit: | < 450 mA pendant max. 100 ms |
| Force: | 100 N +5 % |
| Type de protection: | IP 54 |
| Température ambiante: | 0 °C ... 60 °C |
| Température de stockage: | -25 °C ... 60 °C |

ITA

Dati tecnici:

| | |
|----------------------------|-----------------------------------|
| Tensione d'esercizio: | 120 V AC, -15 %...+15 %, 50/60 Hz |
| Potenza d'esercizio: | 1 W |
| Corrente d'inserzione: | < 450 mA per max. 100 ms |
| Forza: | 100 N +5 % |
| Grado di protezione: | IP 54 |
| Temperatura ambiente: | 0 °C ... 60 °C |
| Temperatura di stoccaggio: | -25 °C ... 60 °C |

ESP

Datos técnicos:

| | |
|--------------------------|-----------------------------------|
| Tensión: | 120 V AC, -15 %...+15 %, 50/60 Hz |
| Potencia de servicio: | 1 W |
| Corriente de cierre: | < 450 mA para un máximo de 100 ms |
| Fuerza: | 100 N +5 % |
| Grado de protección: | IP 54 |
| Temperatura ambiente: | 0 °C ... 60 °C |
| Temp. de almacenamiento: | -25 °C ... 60 °C |

NLD

Technische gegevens:

| | |
|-----------------------|-----------------------------------|
| Bedrijfsspanning: | 120 V AC, -15 %...+15 %, 50/60 Hz |
| Bedrijfsvermogen: | 1 W |
| Inschakelstroom: | < 450 mA voor max. 100 ms |
| Kracht: | 100 N +5 % |
| Veiligheidsklasse: | IP 54 |
| Omgevingstemperatuur: | 0 °C ... 60 °C |
| Opslagtemperatuur: | -25 °C ... 60 °C |

POL

Dane techniczne:

| | |
|--------------------------|-----------------------------------|
| Napięcie robocze: | 120 V AC, -15 %...+15 %, 50/60 Hz |
| Moc napędowa: | 1 W |
| Maks. prąd włączenia: | < 450 mA dla maks. 100 ms |
| Siła nastawcza: | 100 N +5 % |
| Stopień ochrony: | IP 54 |
| Temperatura otoczenia: | 0 °C ... 60 °C |
| Temperatura składowania: | -25 °C ... 60 °C |

DAN

NOR

Tekniske data:

| | |
|-----------------------|-----------------------------------|
| Driftsspænding: | 120 V AC, -15 %...+15 %, 50/60 Hz |
| Driftseffekt: | 1 W |
| Startstrøm: | < 450 mA i max. 100 ms |
| Kraft: | 100 N +5 % |
| Beskyttelsesklasse: | IP 54 |
| Omgivelsestemperatur: | 0 °C ... 60 °C |
| Oplagringstemperatur: | -25 °C ... 60 °C |

SWE

Tekniska data:

| | |
|-----------------------|-----------------------------------|
| Driftsspänning: | 120 V AC, -15 %...+15 %, 50/60 Hz |
| Drifteffekt: | 1 W |
| Inkopplingsström: | < 450 mA för max 100 ms |
| Kraft: | 100 N +5 % |
| Skyddssätt: | IP 54 |
| Omgivningstemperatur: | 0 °C ... 60 °C |
| Lagringstemperatur: | -25 °C ... 60 °C |

FIN

Tekniset tiedot:

| | |
|-----------------------|-----------------------------------|
| Toimintajännite: | 120 V AC, -15 %...+15 %, 50/60 Hz |
| Käyttöteho: | 1 W |
| Kytentävirta: | < 450 mA enint. 100 ms:lle |
| Voima: | 100 N +5 % |
| Suojan laatu: | IP 54 |
| Ympäristön lämpötila: | 0 °C ... 60 °C |
| Varastointilämpötila: | -25 °C ... 60 °C |

RUS

Технические данные

| | |
|-------------------------|-----------------------------------|
| Рабочее напряжение: | 120 В AC, -15 %...+15 %, 50/60 Гц |
| Рабочее мощность: | 1 Вт |
| Ток включения: | < 450 mA макс. 100 ms |
| Сила: | 100 N +5 % |
| Степень защиты: | IP 54 |
| Темп. окружающей среды: | 0 °C ... 60 °C |
| Темп. складирования: | -25 °C ... 60 °C |

